

◆ Valve Regulated Lead Acid Battery(VRLA)

ESP130-12 (12V, 130Ah/10Hr)

► Applications

- Solar, Renewable , UPS, Telecoms

► Technical Features

- Sealed Construction
- Absorbent Glass Mat System(AGM System)
- Gas Recombination
- Low Pressure Venting System
- Maintenance Free

► Specifications

Nominal Capacity(AH)	• 130	
Nominal Voltage(V)	• 12	
Dimensions(L*W*H*TH)	• 550*168*198*237(mm)	
Weight(kg)	• 37.6	
Design life(at 25°C)	Cycle	• DOD50% 1000 cycle
	Float	• 10 years
Internal resistance(mΩ, at 25°C)	• 3.0	
Self Discharge(at 25°C)	• 3% / Month	
Operational Temperature Range	Storage	• -15 ~ 40°C
	Discharge	• -15 ~ 45°C
	charge	• 0 ~40°C
Charge voltage (at 25°C)	Cyclic use	• 14.4V
	Standby use	• 13.32V



► Lay out

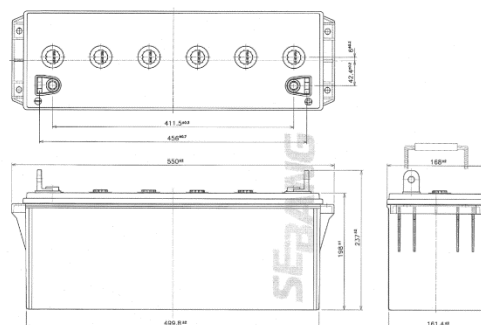

► Terminals

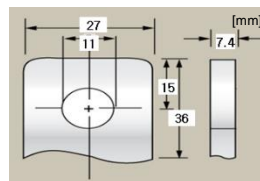

► Performance Data (constant current-ampere, at 25°C)

Final Voltage	5min	15min	30min	45min	1h	2h	3h	5h	8h	10h	20h	100h
1.8V / Cell	325	184	125	91.1	74.3	44.8	32.1	21.0	14.1	13.0	7.0	1.40
1.7V / Cell	366	208	129	96.8	80.0	47.7	34.7	22.8	14.9	13.2	7.1	1.56
1.6V / Cell	426	226	133	99.4	82.2	49.3	36.2	23.6	16.6	13.4	7.2	1.62

► Performance Data (constant Watts, at 25°C)

Final Voltage	5min	10min	15min	20min	30min	40min	50min	1hr	2hr	3hr	5hr	8hr	10hr
1.8V / Cell	3002	2564	2186	1879	1485	1249	1074	948	559	406	269	183	150
1.75V / Cell	3422	2739	2301	1984	1545	1281	1094	966	565	410	273	185	152
1.7V / Cell	3817	2889	2426	2059	1585	1304	1109	978	570	412	275	186	153
1.6V / Cell	4422	3104	2506	2114	1615	1329	1129	993	580	417	278	187	154